

Product Information



Strengthening in case of thin worktops

For the strengthening in case of use of thin worktops

Planning notes:

In case of the use of LEICHT worktops, these strengthenings are fixed automatically without extra costs.

For existing worktops the strengthenings can be ordered – ref. AN AP2 GRP1

Installation instructions:

Fitting of the strengthenings at the plant

Pls. pay attention for specific solutions in cooking and sink areas.

See price and type list – page 24.06

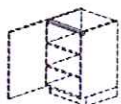

**Einsatz einer Metalltraverse
vorne**
zur Verstärkung des Schrankes
für dünne Arbeitsplatten bauseits

Für Schränke ab 80 cm Breite.

AN AP2 GRP1

134